

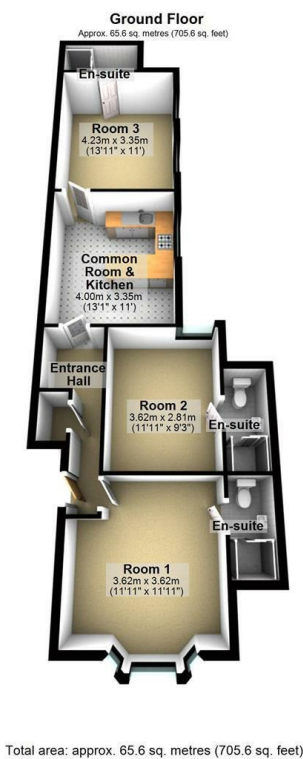

Room 1, 52A Reginald Street, Luton, Bedfordshire, LU2 7QZ  
£650 PCM

- Large Double Room In House Share
  - Available For Immediate Move In
  - Luxury Finish
- Fully Furnished
  - Close to Town Center
  - En Suite Bathroom
- All Bills Included
  - Walking Distance To Station

\*\*\* P&R PROPERTY LETTINGS \*\*\* Large Double Bedroom In Fabulous New House Share \*\*\* LUXURY MODERN FINISH \*\*\* PRIVATE EN SUITE BATHROOM \*\*\* Furniture Included \*\*\* ALL BILLS INCLUDING INTERNET WIFI INCLUDED \*\*\* Close to Town Center \*\*\* Walking Distance To Luton Station \*\*\* AVAILABLE FOR IMMEDIATE MOVE IN \*\*\*



Energy Efficiency Rating		
	Current	Potential
Very energy efficient - lower running costs		
(92 plus) <b>A</b>		
(81-91) <b>B</b>		
(69-80) <b>C</b>		
(55-68) <b>D</b>		
(39-54) <b>E</b>		
(21-38) <b>F</b>		
(1-20) <b>G</b>		
Not energy efficient - higher running costs		
England & Wales		EU Directive 2002/91/EC